

KEEN PROPERTY TRACT
 NUMBER OF MERCHANTABLE TREES BY DBH AND LOG LENGTHS
 P U L P W O O D

| DBH | PINE Trees | Volume | Total Trees | Volume |
|-----|---------------|--------|----------------|--------|
| 6 | 140 | 6.3 | 140 | 6.3 |
| 8 | 350 | 35.0 | 350 | 35.0 |
| 10 | 140 | 23.2 | 140 | 23.2 |
| 12 | 30 | 7.9 | 30 | 7.9 |
| 14 | | | | |
| 16 | | | | |

 660 72.4 660 72.4
 NOTE: PULPWOOD VOLUME SHOWN IN STANDARD CORDS

S A W T I M B E R

| DBH | 1 | 2 | 3 | 4 |
|-----|----|-----|-----|---|
| 10 | | 510 | | |
| 12 | 20 | 317 | 370 | |
| 14 | 23 | 174 | 204 | 2 |
| 16 | 11 | 35 | 30 | |
| 18 | 1 | 12 | 2 | |
| 20 | | | | |
| 22 | | | | |
| 24 | | | | |
| 26 | | | | |
| 28 | | | | |
| 30 | | | | |
| 32 | | | | |
| 34 | | | | |
| 36 | | | | |
| 38 | | | | |
| 40 | | | | |

| DBH | --- PINE --- Trees | Vol | Total Trees | Volume |
|-----|-----------------------|------|----------------|--------|
| 10 | 510 | 18.4 | 510 | 18.4 |
| 12 | 707 | 45.8 | 707 | 45.8 |
| 14 | 403 | 44.3 | 403 | 44.3 |
| 16 | 76 | 11.3 | 76 | 11.3 |
| 18 | 15 | 3.0 | 15 | 3.0 |
| 20 | | | | |
| 22 | | | | |
| 24 | | | | |
| 26 | | | | |
| 28 | | | | |
| 30 | | | | |
| 32 | | | | |
| 34 | | | | |
| 36 | | | | |
| 38 | | | | |
| 40 | | | | |

 1,711 122.8 1,711 122.8
 NOTE: SAWTIMBER VOLUME IN THOUSAND BOARD FEET, DOYLE SCALE

Keen Property
Township 9 North, Range 12 East
Neshoba County, Mississippi

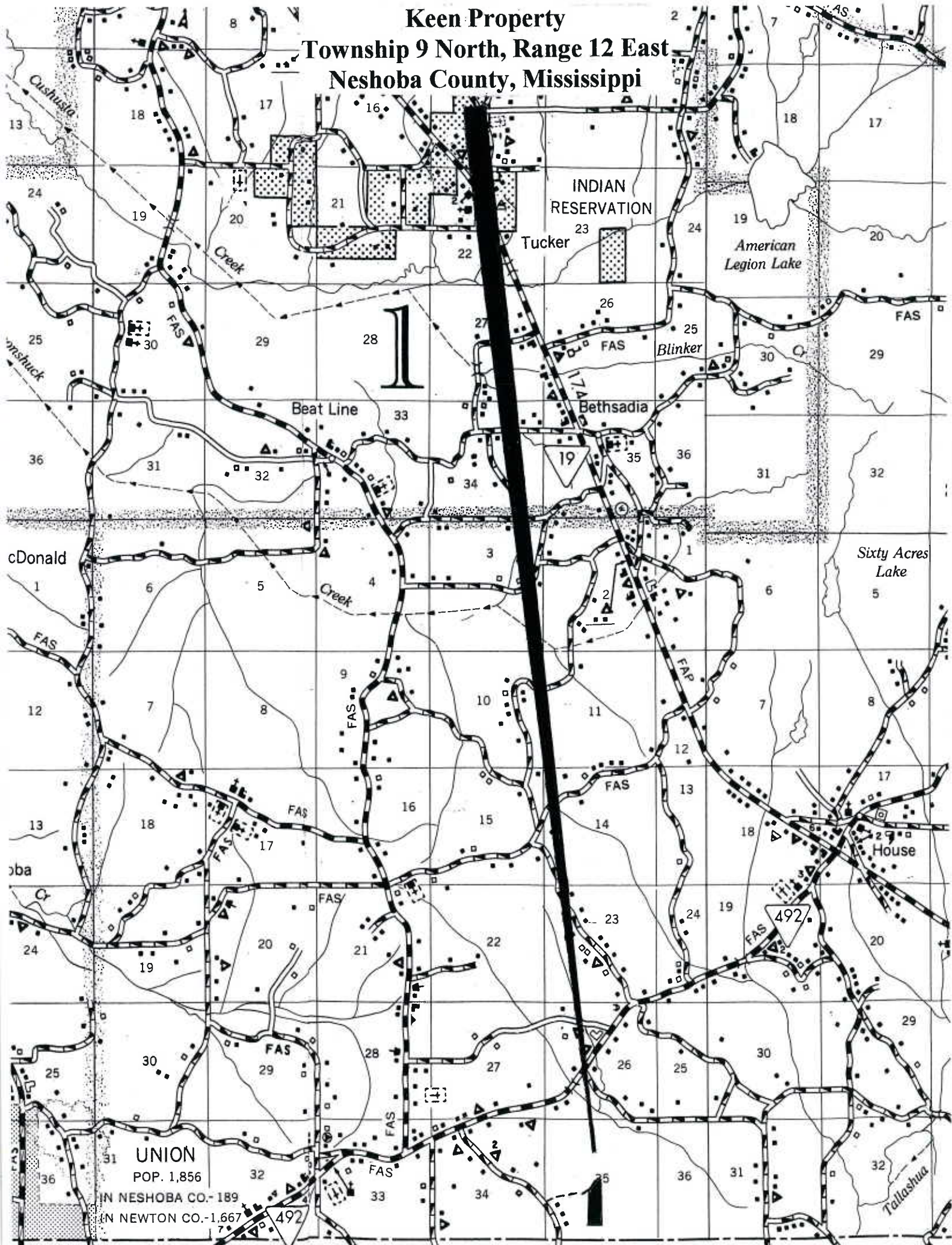

UNION
POP. 1,856

IN NESHOBA CO. - 189
IN NEWTON CO. - 1,667

492

492

1

Keen Tract
Sec. 35, Twp. 9 North, Rng. 12 East
Neshoba County, Mississippi



Sale boundaries are flagged with pink flagging.



34 | 35
—+—
3 | 2

Neshoba Co.
Newton Co.

Little Road
Meridian

Scale = 1" = 83 (In. x US Feet)



GOFORTH FOREST MANAGEMENT, INC.
P.O. Box 2841 • Meridian, MS 39302
Office: 601.693-2738 • Fax: 601.483-5761